

- KEY
- PROPOSED/RELOCATED SIGN POST
 - PROPOSED TYPE 1 CYCLE STAND
 - PROPOSED TYPE 2 CYCLE STAND

- KEY
- EXISTING KERB
 - EXISTING ROAD MARKINGS
 - EXISTING SINGLE / DOUBLE YELLOW LINE
 - PROPOSED NEW KERB
 - PROPOSED NEW 300x200mm CHAMFERED KERB
 - EXISTING GULLY
 - EXISTING POST BOX
 - EXISTING TACTILE PAVING
 - EXISTING SIGN POST
 - EXISTING BELISHA BEACON
 - EXISTING LAMP COLUMN
 - EXISTING RAISED JUNCTION TREATMENT- EXTENT OF NEW SURFACING CARRIED OUT IN APRIL 2014
 - PROPOSED CARRIAGEWAY HRA SURFACE COURSE TO A DEPTH OF 40mm
 - PROPOSED YORKSTONE PAVING (600xRANDOM LENGTH x65mm) ON 50mm SAND/CEMENT MORTAR BED, ON C16 CONCRETE BASE (100mm APPROX.)
 - PROPOSED CARRIAGEWAY GRANITE SETTS - 60% DARK GREY/40% MID GREY (250x150x100mm) ON 50mm SAND/CEMENT MORTAR BED, ON 200mm C20 WET LEAN CONCRETE
 - PROPOSED/RELAID GRANITE SETTS 100x100x200mm THICK, ON 50mm SAND/CEMENT MORTAR BED, ON 200mm C20 WET LEAN CONCRETE
 - PROPOSED GUYANAN ANTI-SKID LAYER
 - PROPOSED CARRIAGEWAY AREA TO BE RE-PROFILED AND RECONSTRUCTED IN 40mm HRA SURFACE COURSE, ON 60mm SMA BINDER COURSE
 - PROPOSED YORKSTONE SLABS (600x300x65mm), ON 50mm SAND/CEMENT MORTAR BED, ON C15 CONCRETE BASE (100mm APPROX.), TO BE PROVIDED AS AN OPEN DRAINAGE CHANNEL (300mm WIDE SINGLE ROW)
 - PROPOSED WHITE ROAD MARKINGS
 - PROPOSED YELLOW LINES
 - EXISTING SERVICE COVERS TO BE RAISED OR LOWERED, TO SUIT NEW LEVELS
 - PROPOSED RECESSED COVER
 - EXISTING PRIVATE SKYLIGHTS
 - PROPOSED YORKSTONE TACTILE PAVING (400x400x65mm)
 - NEW 150mm INT DIA. HDPE (TWIN-WALLED) DRAINAGE PIPE TO REPLACE DAMAGED DRAIN RUN
 - PROPOSED 8m LARGE GREY WORNUM LIGHTING COLUMN
 - PROPOSED BELISHA BEACON POST TYPE D WITH MIDUBEL GLOBE AND SILL PLATINE 454 CITY PROJECTOR

NEW "ONE 2 SEE" INT ILLUMINATED LED SIGN (DIAG. 616) TO BE PROVIDED ON EXISTING WIDE BASED POST

NEW "ONE 2 SEE" INT ILLUMINATED LED SIGN (DIAG. 616) TO BE PROVIDED ON EXISTING WIDE BASED POST

STREET SIGN PLATE TO BE MOUNTED ON EXTERIOR WALL OF No. 44 WELLINGTON STREET, FOLLOWING COMPLETION OF WAYLEAVE AGREEMENT

EXISTING BUS STOP FLAG

EXISTING GULLY TO BE RETAINED

FOOTWAY WIDENED BY 1.5m

PROPOSED CHAMFERED KERB TO BE CURTAILED EITHER SIDE OF EXISTING TWIN MANHOLE MANHOLE COVER TO BE RAISED TO LEVEL OF LOADING PAD

FOOTWAY WIDENED BY 1.5m

PARKING TO BE AMENDED TO CREATE TWO NEW PAY-BY-PHONE BAYS

PROPOSED 17 No. REMOVABLE CYCLE STANDS ON NAL SOCKET BASES TYPE RS48 OR SIMILAR APPROVED

NEW "ONE 2 SEE" INT ILLUMINATED LED SIGN (DIAG. 652) TO BE PROVIDED ON A NEW WIDE BASED POST

NEW "ONE 2 SEE" INT ILLUMINATED LED SIGN (DIAG. 652) TO BE PROVIDED ON A NEW WIDE BASED POST

EXISTING CYCLE DIRECTION SIGNS 3 No. TO DIAG. 2602.1 TO BE MOUNTED ON A NEW NARROW POST

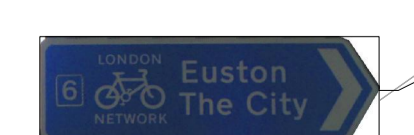

REV	DATE	BY	DESCRIPTION	CHK	APP
C	10.10.2014	PAD	NEW SIGNS AND ADDITIONAL DRAINAGE WORKS ADDED	PF	CB
B	26.09.2014	PAD	SIGN POST RELOCATED, HATCH MARKING ADDED		
A	05.08.2014	PAD	INITIAL ISSUE		

DRAWING STATUS: INITIAL DESIGN

West One
 West One Infrastructure Services
 10th Floor 64 Victoria Street London SW1E 6QP
 Tel: +44 (0) 20 7811 6300 Fax: +44 (0) 20 7811 6301
<http://www.westonejv.co.uk>

City of Westminster
 SAFE STREETS
 City Commissioner of Transportation

PROJECT: WELLINGTON STREET PUBLIC REALM SCHEME
 TITLE: OPTION 1 GENERAL ARRANGEMENT

SCALE @ A1	DATE	DESIGN/DRAWN	CAD CHECKED	CHECKED	APPROVED	SHT
1:200	05.08.2014	RC/PAD	JS	PF	CB	A1
JOB No.	11677201		BRIF/DSB No.		BR 13779	
DRAWING No.	11677201-02-GA-02		REV.		C	

This map is reproduced from Ordnance Survey material with the permission of Ordnance Survey on behalf of the Controller of Her Majesty's Stationery Office © Crown copyright. Unauthorised reproduction infringes Crown copyright and may lead to prosecution or civil proceedings. (WCC)(A 1000997)



EXISTING LAYOUT

WELLINGTON STREET - CHANGES TO ROAD MARKINGS IN AFFECTED AREA

RESTRICTION TYPE	EXISTING	PROPOSED	DIFFERENCE
SINGLE YELLOW LINE	23.1m	7.8m	-15.3m
DOUBLE YELLOW LINE	27.9m	78.6m	+50.7m
RESIDENTS' PARKING BAYS	10.9m	0.0m	-10.9m
PAY-BY-PHONE PARKING BAYS	52.0m	35.2m	-16.8m
LOADING PAD MON - SUN, 7am - 11am	0.0m	11.3m	+11.3m
CAR CLUB PARKING BAYS	9.9m	9.9m	0.0m

- KEY
- RESIDENTS PARKING
 - PAY BY PHONE PARKING
 - CAR CLUB PARKING
 - LOADING PAD
 - BB PROPOSED BELISHA BEACON
 - LC PROPOSED LAMP COLUMN
 - P PROPOSED SIGN POST
 - EXISTING YELLOW LINE
 - PROPOSED YELLOW LINE
 - PROPOSED WHITE LINE

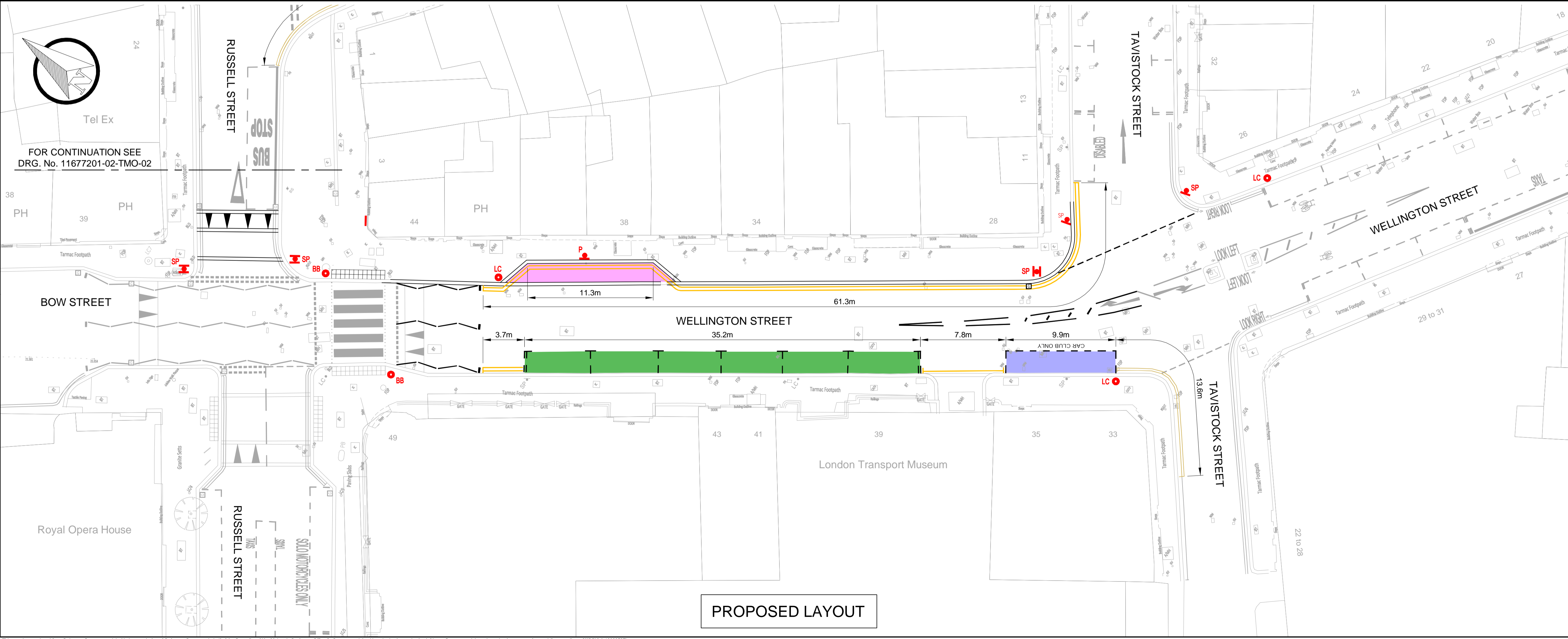

PROPOSED LAYOUT

REV	DATE	BY	DESCRIPTION	CHK	APP
A	22.10.2014	PAD	INITIAL ISSUE	CDS	CB

DRAWING STATUS: CONSULTATION

CLIENT: City of Westminster
SAFE STREETS
City Commissioner of Transportation

PROJECT: WELLINGTON STREET
PUBLIC REALM SCHEME

TITLE: PHASE 2
WELLINGTON STREET
TMO LAYOUT - SHEET 1 OF 4

SCALE @ A1	DATE	DESIGN/DRAWN	CHECKED	APPROVED	SHT
1:200	15-10-2014	JO/PAD	CDS	CB	A1

JOB No. 11677201 BREFIDSB No. BR 13779

DRAWING No.	REV.
11677201-02-TMO-01	A

T:\11677201-02-TMO-01-00.dwg 22 Oct 2014 13:38m

This map is reproduced from Ordnance Survey material with the permission of Ordnance Survey on behalf of the Controller of Her Majesty's Stationery Office © Crown copyright. Unauthorised reproduction infringes Crown copyright and may lead to prosecution or civil proceedings. (WCC)(LA 1000997)

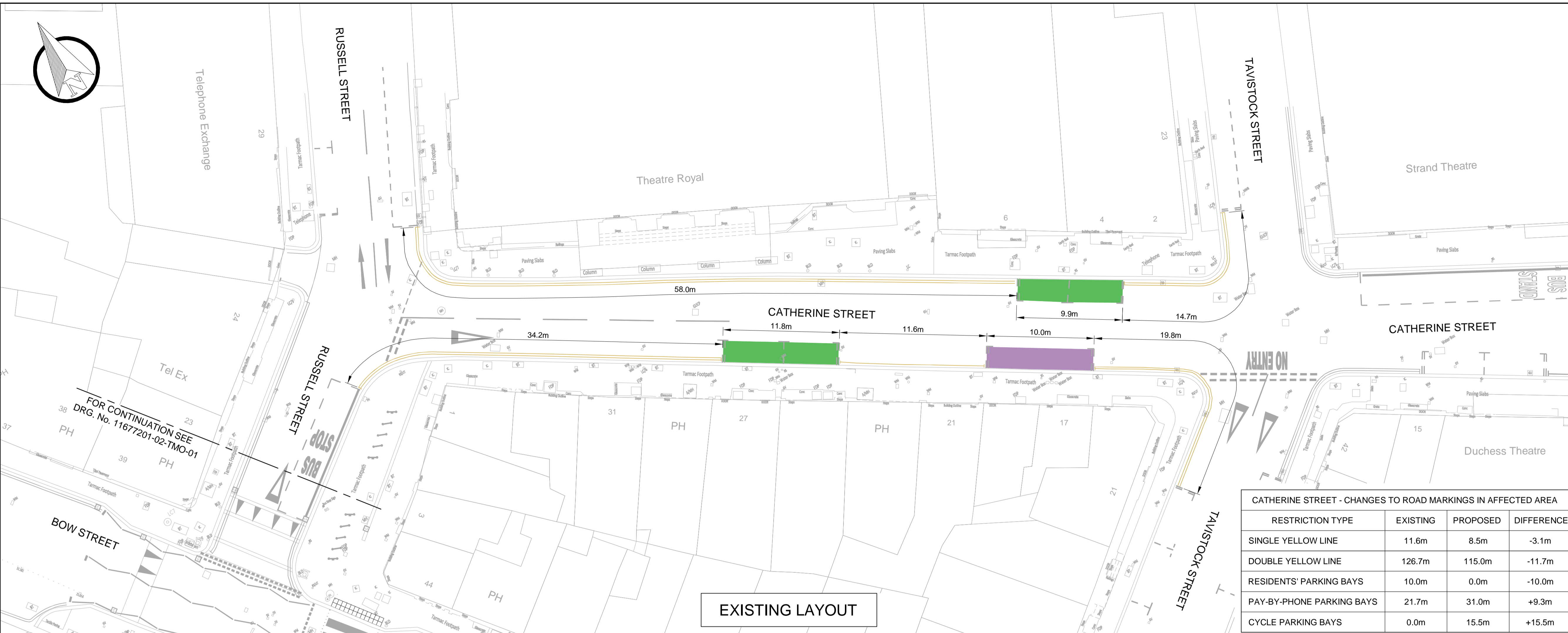

EXISTING LAYOUT

CATHERINE STREET - CHANGES TO ROAD MARKINGS IN AFFECTED AREA			
RESTRICTION TYPE	EXISTING	PROPOSED	DIFFERENCE
SINGLE YELLOW LINE	11.6m	8.5m	-3.1m
DOUBLE YELLOW LINE	126.7m	115.0m	-11.7m
RESIDENTS' PARKING BAYS	10.0m	0.0m	-10.0m
PAY-BY-PHONE PARKING BAYS	21.7m	31.0m	+9.3m
CYCLE PARKING BAYS	0.0m	15.5m	+15.5m

KEY

- RESIDENTS PARKING
- PAY BY PHONE PARKING
- EXISTING YELLOW LINE
- PROPOSED YELLOW LINE
- PROPOSED WHITE LINE
- PROPOSED CYCLE STANDS

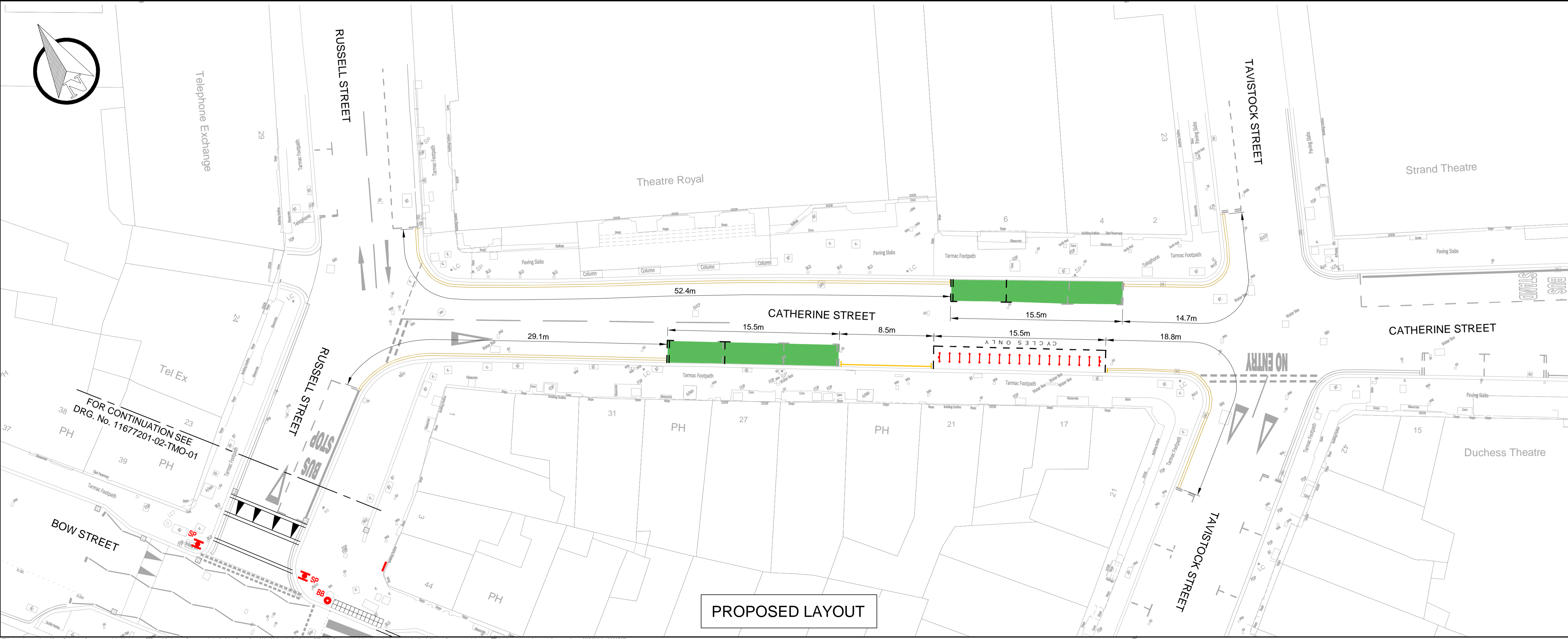

PROPOSED LAYOUT

REV	DATE	BY	INITIAL	ISSUE	CDS	CB
A	22.10.2014	PAD		INITIAL ISSUE		

DRAWING STATUS: **CONSULTATION**

CLIENT: **City of Westminster**
SAFE STREETS
City Commissioner of Transportation

PROJECT: **WELLINGTON STREET PUBLIC REALM SCHEME**

TITLE: **PHASE 2 CATHERINE STREET TMO LAYOUT - SHEET 2 OF 4**

SCALE @ A1	DATE	DESIGN/DRAWN	CHECKED	APPROVED	SHT
1:200	15-10-2014	JO/PAD	CDS	CB	A1





JOB No.	11677201	BRIEF/D88 No.	BR 13779
DRAWING No.	11677201-02-TMO-02	REV.	A

This map is reproduced from Ordnance Survey material with the permission of Ordnance Survey on behalf of the Controller of Her Majesty's Stationery Office © Crown copyright. Unauthorised reproduction infringes Crown copyright and may lead to prosecution or civil proceedings. (WCC)(LA10009697)

DRURY LANE - CHANGES TO ROAD MARKINGS IN AFFECTED AREA			
RESTRICTION TYPE	EXISTING	PROPOSED	DIFFERENCE
SINGLE YELLOW LINE	0.0m	0.0m	0.0m
DOUBLE YELLOW LINE	162.8m	151.8m	-11.0m
RESIDENTS' PARKING BAYS	49.0m	60.0m	+11.0m
PAY-BY-PHONE PARKING BAYS	49.9m	49.9m	0.0m
SOLO MOTORCYCLE BAYS	14.7m	14.7m	0.0m

KEMBLE STREET - CHANGES TO ROAD MARKINGS IN AFFECTED AREA			
RESTRICTION TYPE	EXISTING	PROPOSED	DIFFERENCE
SINGLE YELLOW LINE	4.3m	4.3m	0.0m
DOUBLE YELLOW LINE	71.9m	60.9m	-11.0m
RESIDENTS' PARKING BAYS	119.0m	130.0m	+11.0m
PAY-BY-PHONE PARKING BAYS	22.6m	22.6m	0.0m

KEY

-  PROPOSED RESIDENTS PARKING
-  PROPOSED SIGN AND POST
-  EXISTING YELLOW LINE
-  PROPOSED YELLOW LINE

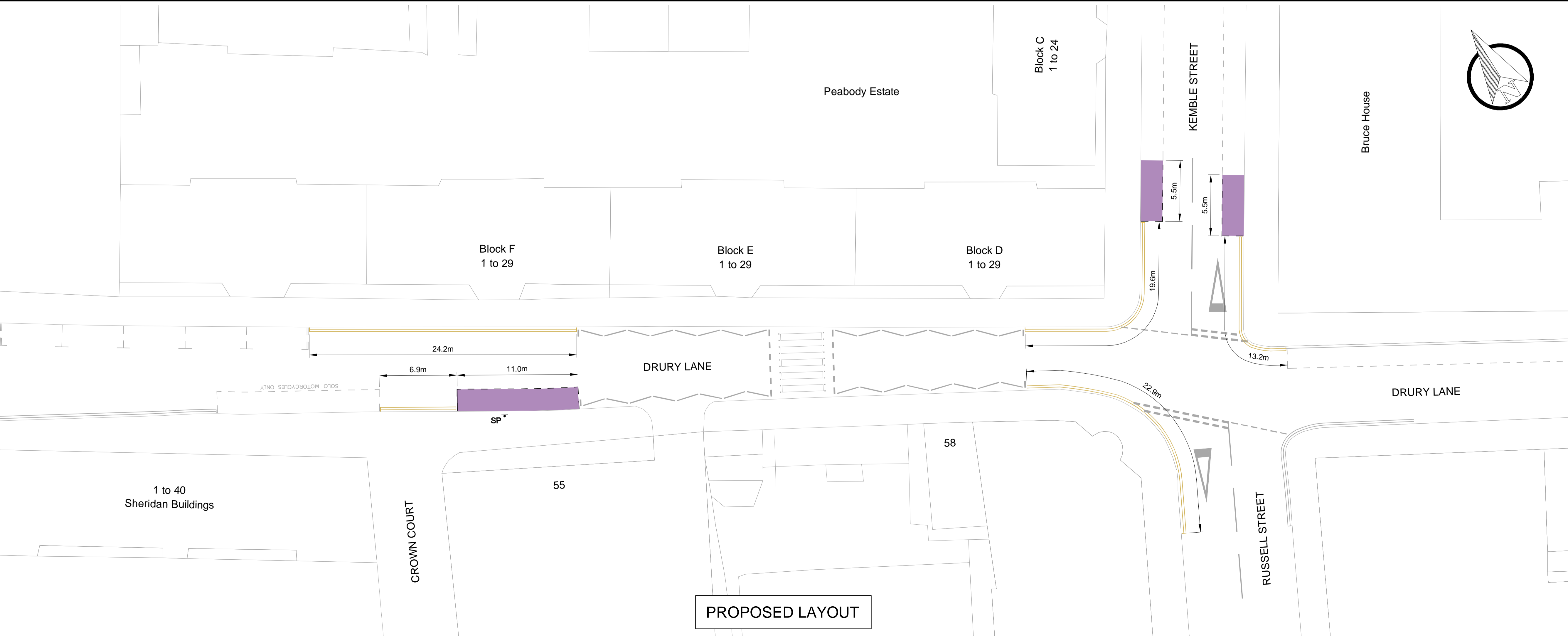
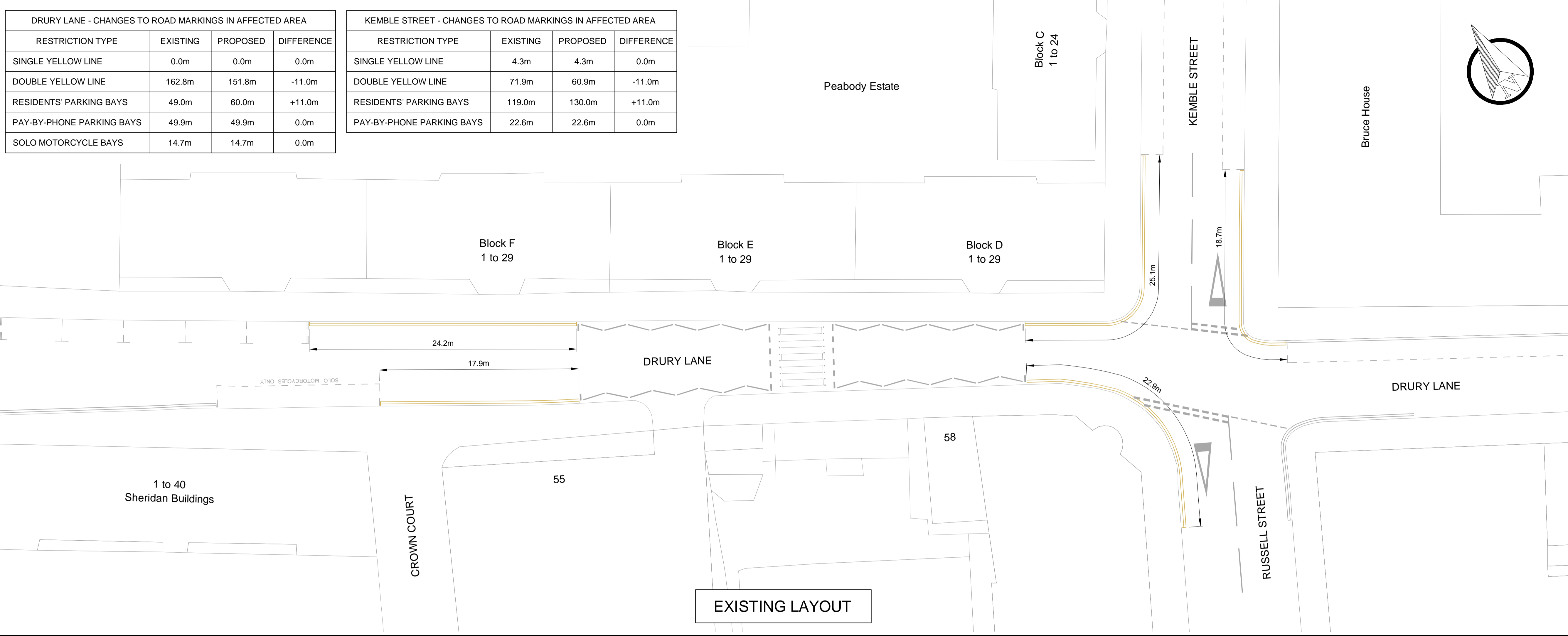

REV	DATE	BY	DESCRIPTION	CHK	APP
A	22.10.2014	PAD	INITIAL ISSUE	CDS	CB

DRAWING STATUS: CONSULTATION



PROJECT: WELLINGTON STREET PUBLIC REALM SCHEME

TITLE: PHASE 2 RELOCATED PROPOSED PARKING TMO LAYOUT - SHEET 3 OF 4

SCALE @ A1	DATE	DESIGN/DRAWN	CHECKED	APPROVED	SHT
1:200	20-10-2014	JO/PAD	CDS	CB	A1

JOB No.	11677201	BREF/D58 No.	BR 13779
---------	----------	--------------	----------

DRAWING No.	11677201-02-TMO-03	REV.	A
-------------	--------------------	------	---

T:\11677201 BR13779 W1208334 Wellington_Catherine_Russell_Sheet\1 Drawings & Photos\Drawings\PHASE 2 NEW\Initial Design\11677201-02-TMO-03.dwg 22 Oct 2014 15:59m
 This map is reproduced from Ordnance Survey material with the permission of Ordnance Survey on behalf of the Controller of Her Majesty's Stationary Office © Crown copyright. Unauthorised reproduction infringes Crown copyright and may lead to prosecution or civil proceedings. (WCC)(LA10009997)

T:\11677201 BR13779 W41208394 Wellington_Catherine... Russell Street\11 Drawings & Photos\Drawings\PHASE 2 NEW\Initial Design\11677201-02-TMO-04.dwg 22 Oct, 2014 - 1:40pm

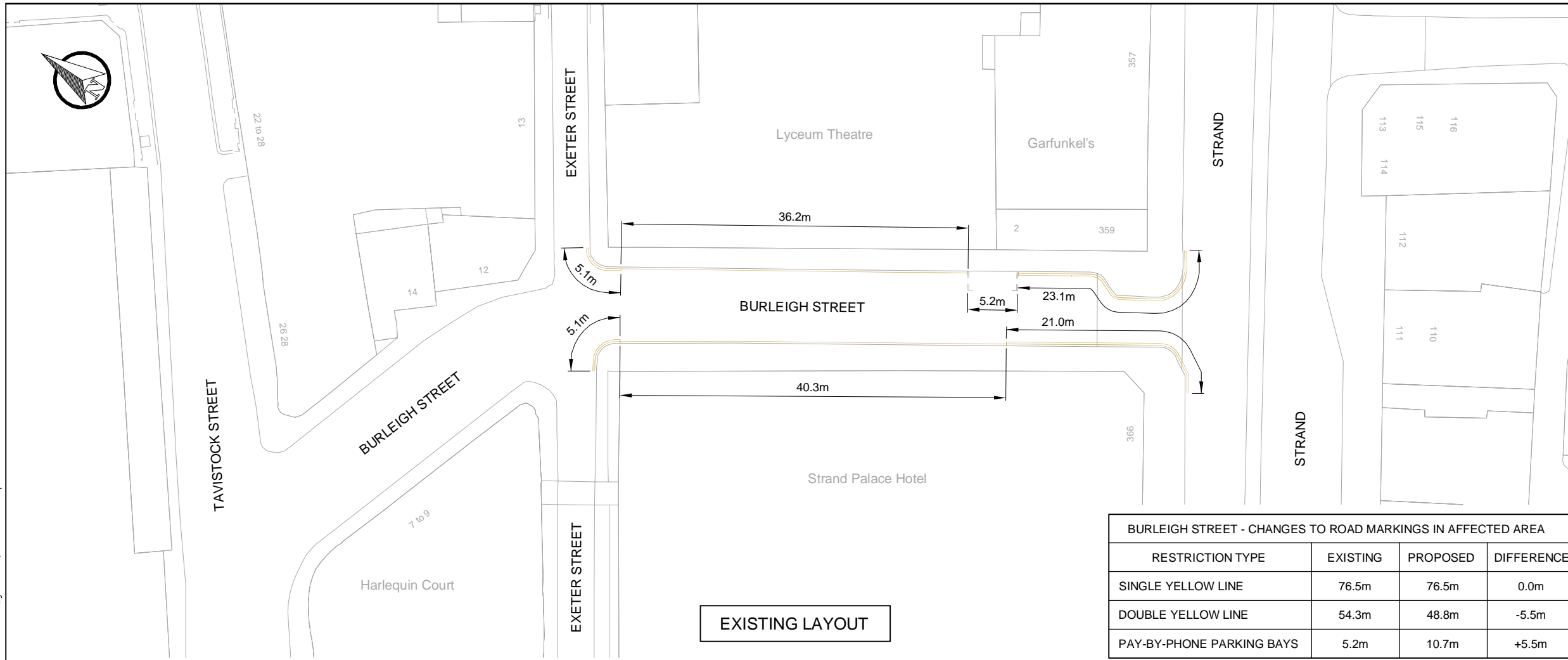

BURLEIGH STREET - CHANGES TO ROAD MARKINGS IN AFFECTED AREA			
RESTRICTION TYPE	EXISTING	PROPOSED	DIFFERENCE
SINGLE YELLOW LINE	76.5m	76.5m	0.0m
DOUBLE YELLOW LINE	54.3m	48.8m	-5.5m
PAY-BY-PHONE PARKING BAYS	5.2m	10.7m	+5.5m

KEY

- PAY BY PHONE PARKING
- EXISTING YELLOW LINE
- PROPOSED YELLOW LINE

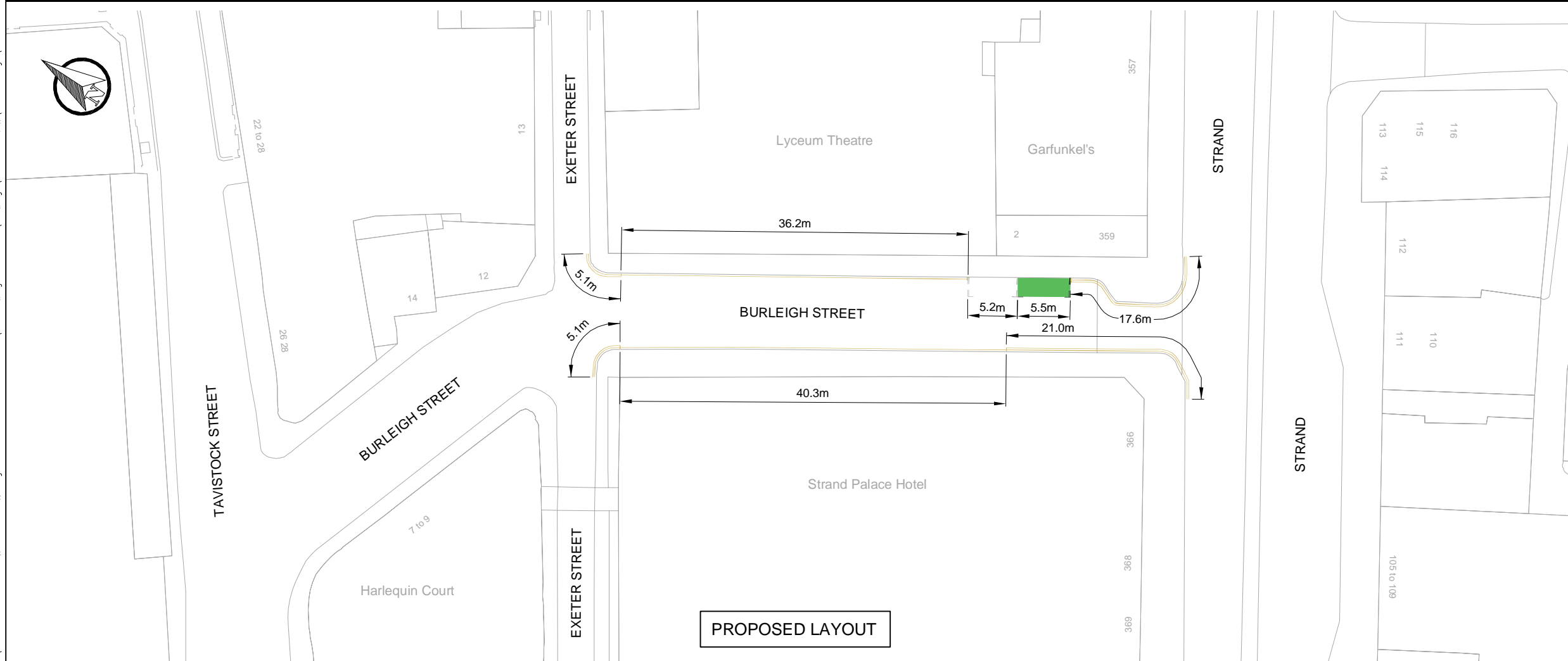

A 22.10.2014 PAD INITIAL ISSUE CDS CB

DRAWING STATUS **CONSULTATION**

25 Mandela Way, London, SE1 5SZ
www.fimconway.co.uk www.wspgroup.com

CLIENT

City of Westminster
SAFE STREETS
City Commissioner of Transportation

PROJECT

**WELLINGTON STREET
PUBLIC REALM SCHEME**

TITLE

**PROPOSED LOCATION FOR
PAY-BY-PHONE BAY
TMO LAYOUT - SHEET 4 OF 4**

SCALE @ A3	DATE	DESIGN/DRAWN	CHECKED	APPROVED	SHT
1:500	21-10-2104	JO/PAD	CDS	CB	A3

JOB No. 11677201 BRIEF/DSB No. BR 13779

DRAWING No. 11677201-02-TMO-04 REV. A